

Opening in the base cut by the customer to suit the pipe being used at the invert height as required.

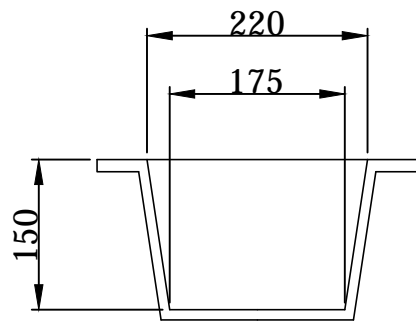

SECTION X-X

- NOTES:**
- All dimensions in mm U.O.S
 - All measurements ± 1mm
- Material**
- Characteristic compressive strength of Glass Reinforced Concrete = 60N/mm²
 - Characteristic flexural strength of Glass Reinforced Concrete = 6N/mm²
 - Free water / Cement ratio: <0.55
 - Glass fibres - 63kg/m³
 - Specification: XA2, DS2, DC2

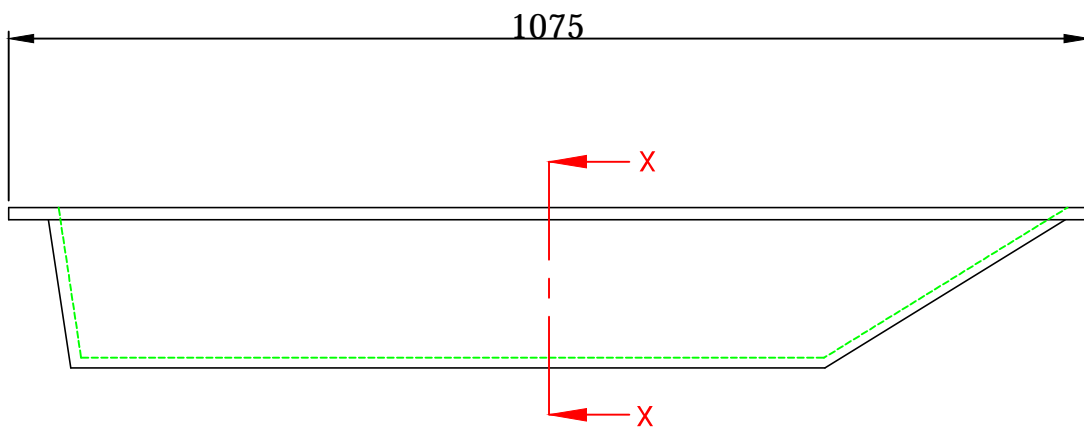
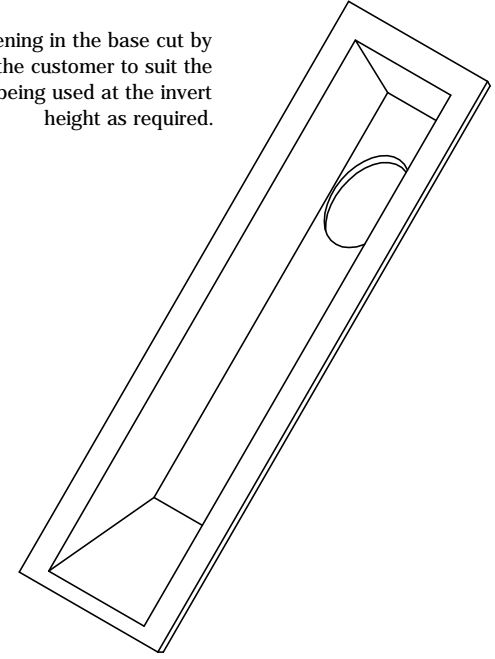

ADDRESS: JKH LIMITED
 HAMPSTEAD AVENUE
 MILBENHULL
 IP24 7AS

TEL: 01638 713795
 FAX: 01638 682507
 EMAIL: info@jkh.co.uk
 WEBSITE: www.jkh.co.uk

PROPRIETARY & CONFIDENTIAL

The information contained in this drawing is the sole property of JKH Drainage Units Limited. Any reproduction in part or in whole without the written permission of JKH Drainage Units Limited is strictly prohibited.

DRAWING TITLE / PROJECT:
GRC Double Ended Dyketector - 1M
 (Glass Reinforced Cement)
 To suit up to 150mm Ø pipe

CLIENT:	
SCALE: NTS	DRAWING DATE: 14/06/2019
HEADWALL WEIGHT: 15kg	ORATING WEIGHT: -kg
TOTAL WEIGHT: 15kg	
DRAWN BY: JP	CHECKED BY: DH
DRAWING No:	

GRC DDE1M-0010

DO NOT SCALE DRAWING